



## Innovation in tele-monitoring of chronic pulmonary diseases

### A novel test of Pulmonary Function: the "Ventilometry"

Resulting from research work carried out by the Aqsitania team, the morphological analysis of respiratory signals is a cutting edge technology already experimented in major hospital centres.

#### This test allows:

- ✓ the definition of new markers of the pulmonary function based on normal rest breathing
- ✓ the emergence of a new concept of respiratory personality: **the PRP, Personal Respiratory Profile**
- ✓ securing the chronic respiratory patient at home

### SIGNAL ANALYSIS SERVICES

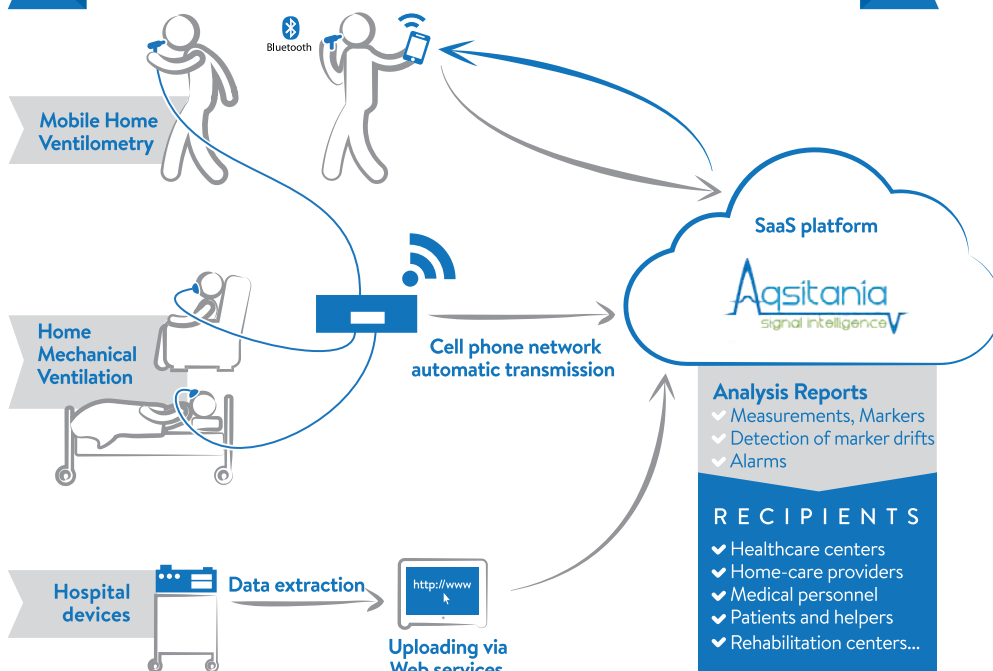

## The Personal Respiratory Profile

A unique « respiratory identification card » of the pulmonary function state. Through acquisition and cycle to cycle analysis of normal rest breathing the PRP summarizes the measurement of sensitive and specific morphological markers.

The PRP follow-up offers the possibility to detect abnormal drifts of breathing behavior, allowing the anticipation of negative evolution, exacerbation (asthma, COPD, ...), pulmonary oedema, treatment adaptation and efficiency evaluation.

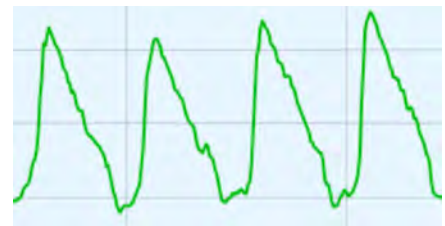
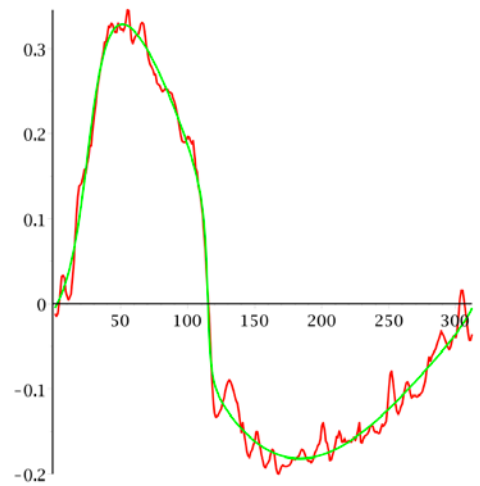

## How does it work ?

It is a safe and easy test which requires little from the patient: it can therefore be used by all, whatever the age or state of health.

The person breathes normally a few minutes in the Ventilometre. Measurements of the respiratory flow are transmitted to the SaaS platform for analysis and interpretation.



*We offer an autonomous apparatus, the Ventilotel<sup>®</sup>, and a device to peer with a smartphone or tablet, the Ventilosmart<sup>®</sup>.*

## Usage and Users

### Personal Respiratory Profile

#### Patients for self test

- ✓ Telemonitoring
- ✓ Home support

#### Healthcare professionals

- ✓ Prevention, screening
- ✓ Rehabilitation

#### Pharmaceutical Industry

- ✓ Clinical trial
- ✓ Pharmacovigilance